

PTO with high engagement for NISSAN M5-35 gearbox

We are glad to inform you that the new PTO's for NISSAN M5-35 gearbox with engagement system in the upper part of PTO body are now available. This version allows a quicker and more efficient mounting compared to a PTO with engagement on the lower part.

The order codes for the several versions are the following:

- Pto with mechanical control: **065-015-00131**
- Pto with electromagnetic control: **065-515-10134**
- Pto with pneumatic control: **066-115-00138**
- Pto with vacuum control: **066-315-00136**



Gearbox	Version	Pto ratio@1000 eng.rpm	Max torque	Mounting side	Output	Rotation	Mounting kit
		rpm	Nm				
NISSAN M5-35	13	1226	128	Sx.	Poster.	Orar.	154-3-3133

NPLA , NPLH and NPLU series gear pumps can be easily mounted on these PTO's. Due to overall dimensions of chassis/gearbox assembly a new special version of NPH series has been realised with income and outcome holes on the rear side to allow mounting.

NPH with rear fittings:

- NPH 17 right: **105-038-00174**
- NPH 17 left: **105-038-00183**
- NPH 22 right: **105-038-00227**
- NPH 22 left: **105-038-00236**

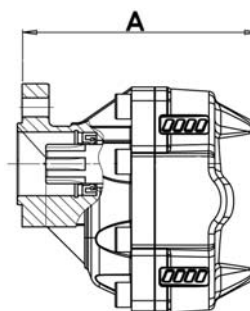

Pump type	Rotation		IN	OUT	A	Weight
	Right	Left				
NPH-17	105-038-00174	105-038-00183	ISO 228	ISO 228	mm	Kg
NPH-22	105-038-00227	105-038-00236	G 3/4	G 1/2	150.5	9.3
					154	9.5

Mounting example

MOUNTING EXAMPLE

